

**SUNDAY MORNING CLASS SCHEDULE**  
 WINTER/SPRING 2017

<b>CHILDREN &amp; YOUTH</b>	<b>8:15 A.M.</b>	<b>9:30 A.M.</b>	<b>11:00 A.M.</b>
Infants (non-mobile)	117	113	113
Crawlers	↓	115	115
Young walkers (born after 8/31/15)		117	117
Toddlers I (3/1/15—8/31/15)		112	117
Toddlers II (9/1/14—2/28/15)		112	117
Twos I (3/1/14—8/31/14)		114	112
Twos II (9/1/13—2/28/14)		114	112
Threes (9/1/12—8/31/13)		116	112
Fours (9/1/11—8/31/12)		120	112
Godly Play I (Grades K—2)	↓	G1	Jesus the Rock "LIVE!" (Grades K—5) in the Chapel (all but the first Sunday of each month) or the Sanctuary
Godly Play II (Grades 3—6)		G2	
Kindergarten		123A	
Grade 1		125	
Grade 2		203/205	
Grade 3		202/204	
Grade 4		206/208	
Grade 5		206/208	
Grades 6		Molly McKay House	↓
Grades 7—8 (Confirmation Class is in the Molly McKay House from 10:45 a.m.—noon)		Molly McKay House	
Grades 9—12		Molly McKay House	

<b>ADULT CLASSES</b>	<b>9:30 A.M.</b>
Adult Bible Study	216/218
Bill Hight Class (primarily senior adults, but all are welcome)	222
Faith in Action (couples and singles born in the 60s-70s)	213
Life Applications Class (interactive class for those over 40)	Congregational Care House
Navigators (class is diverse in age; 40s—70s)	Davidson Town Hall
Logos (a principle which refers to a universal divine reason)	209
Shalom (justice, interfaith dialogue, and emerging perspectives)	220
Young Families	215



**\* Main Level \***

Hwy 115/Main Street

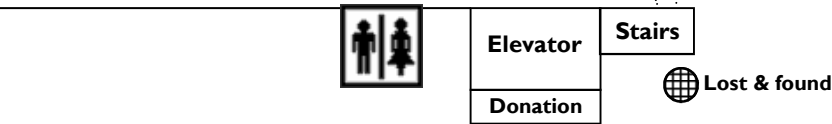
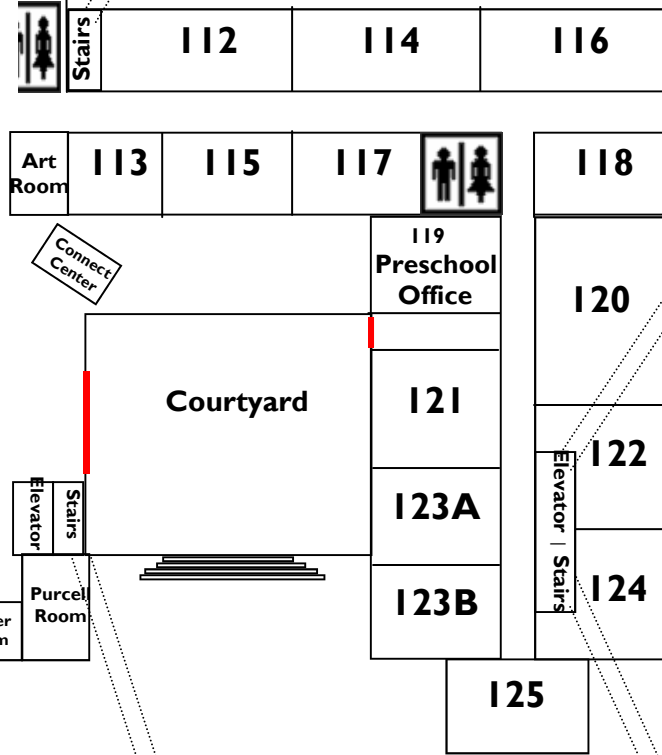
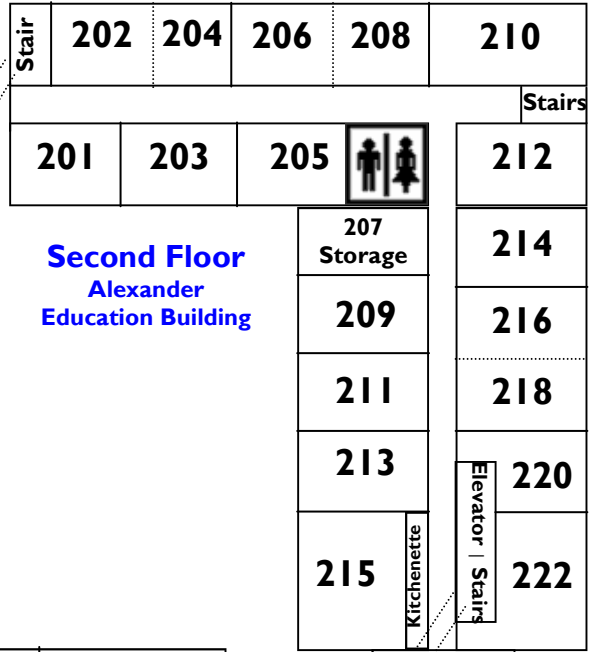
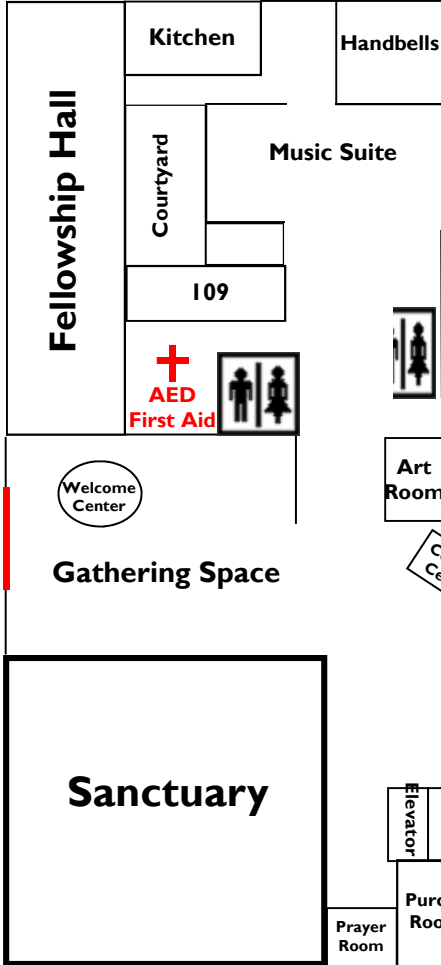

← Staff Offices and Library

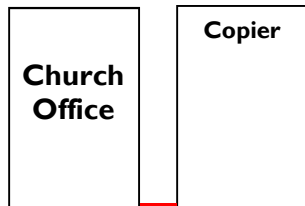

**Ground Level/Parking Lot**

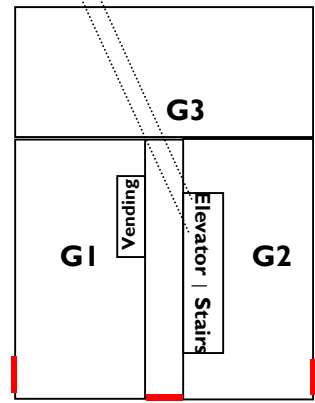
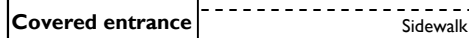

Covered drive/drop-off